

# THE STAIRWAY TO NOWHERE

## A VILLAGE FOLLY\*

(With Apologies to M.C. Escher and Luis Barragan)

This folly was commissioned by our Village as a symbol to remind our citizens of the larger follies that are often foisted\*\* upon us, by our elected officials.

\*FOLLY: A functionally useless structure, often a fake ruin, sometimes built in a landscape park to highlight a view.

\*\* foist: To impose (something unwanted) upon another by coercion or trickery. To insert fraudulently or deceitfully.

This folly brought to you with much dedication and tongue in cheek by:

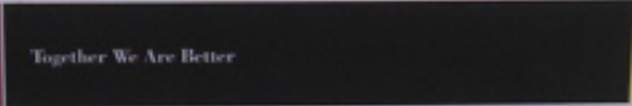
The logo for HDR, consisting of the letters 'HDR' in a white serif font on a dark red rectangular background.The logo for 'Together We Are Better', consisting of the text 'Together We Are Better' in a white sans-serif font on a black rectangular background.

and



**SUN VALLEY  
MASONRY, INC.**

MASON CONTRACTORS

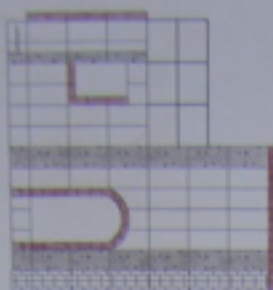

LEFT OUTSIDE ELEVATION

1/2" = 1' SCALE 2. ALIAS PART OF CHAIR TO ARCHIVE Date: 1/1/00 By: [Name]	SHEET 1 OF 3 1/2" = 1' 1/2" = 1' 1/2" = 1'
--	--

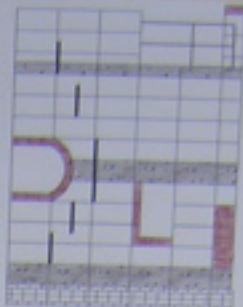

RIGHT OUTSIDE ELEVATION

1/2" = 1' SCALE 2. ALIAS PART OF CHAIR TO ARCHIVE Date: 1/1/00 By: [Name]	SHEET 2 OF 3 1/2" = 1' 1/2" = 1' 1/2" = 1'
--	--

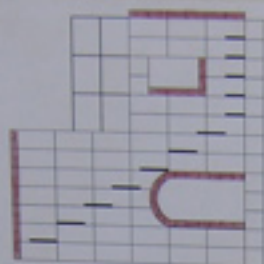

LEFT INSIDE ELEVATION

1/2" = 1' SCALE 2. ALIAS PART OF CHAIR TO ARCHIVE Date: 1/1/00 By: [Name]	SHEET 3 OF 3 1/2" = 1' 1/2" = 1' 1/2" = 1'
--	--

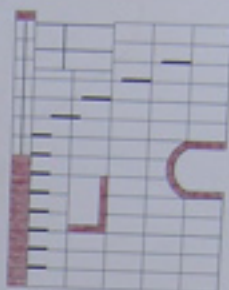

RIGHT INSIDE ELEVATION

1/2" = 1' SCALE 2. ALIAS PART OF CHAIR TO ARCHIVE Date: 1/1/00 By: [Name]	SHEET 4 OF 4 1/2" = 1' 1/2" = 1' 1/2" = 1'
--	--

## THE STAIRWAY TO NOWHERE

### A VILLAGE FOLLY\*

(With Apologies to M.C. Escher and Luis Barragan)

This folly was commissioned by our Village as a symbol to remind our citizens of the larger follies that are often foisted\*\* upon us, by our elected officials.

\*FOLLY: A functionally useless structure, often a fake ruin, sometimes built in a landscape park to highlight a view.  
 \*\* foist: To impose (something unwanted) upon another by coercion or trickery. To insert fraudulently or deceitfully.

This folly brought to you with much dedication and tongue-in-cheek by:

FCR

Franklin County, VA

and



SUN VALLEY  
 MASONRY, INC.  
 MASON CONTRACTORS

